

# INSTALLATION MANUAL

---



01

# Installation instruction

## Installation Requirement

- ☐ 1) The ground surface where the gate is installed should be level
- ☐ 2) The concrete grade  $\geq$  C30 (for outdoor installation)
- ☐ 3) Concrete thickness  $\geq$  200mm
- ☐ 4) The ground must be frost-free and have good bearing capacity
- ☐ 5) The turnstile must be grounded
- ☐ 6) The power cord should be no less than RVV 3x2.0
- ☐ 7) When installing, make sure the body is horizontal and the turning bar is vertical

## Installation

According to the channel requirements place the equipment in good condition ensuring that both ends of the equipment are level and the channel width is consistent



Mark the fixed hole position

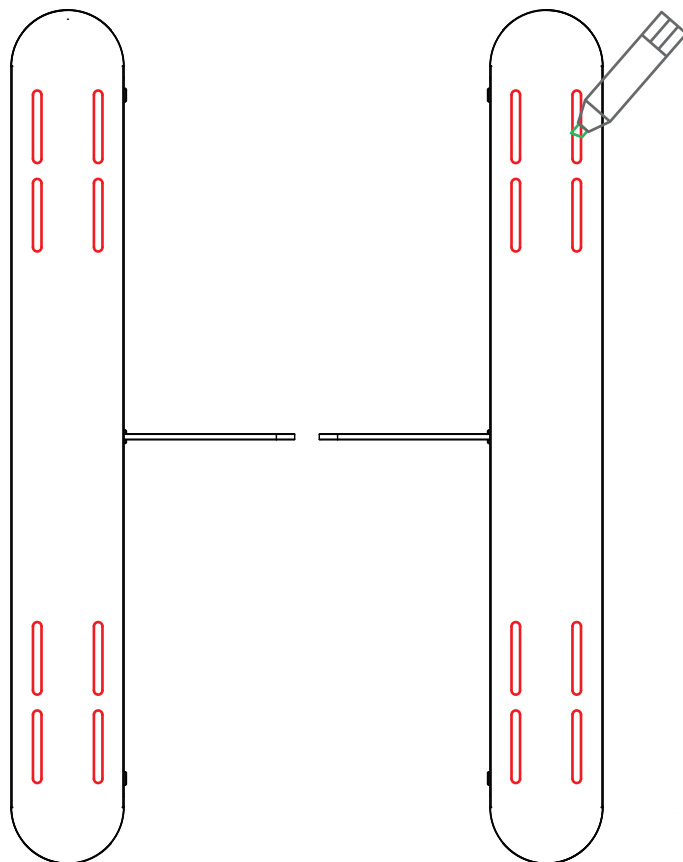

Move the device away and embed M12x100mm expansion screws according to the marked hole positions

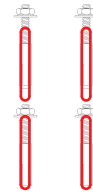
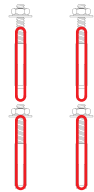
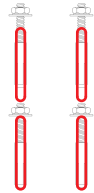



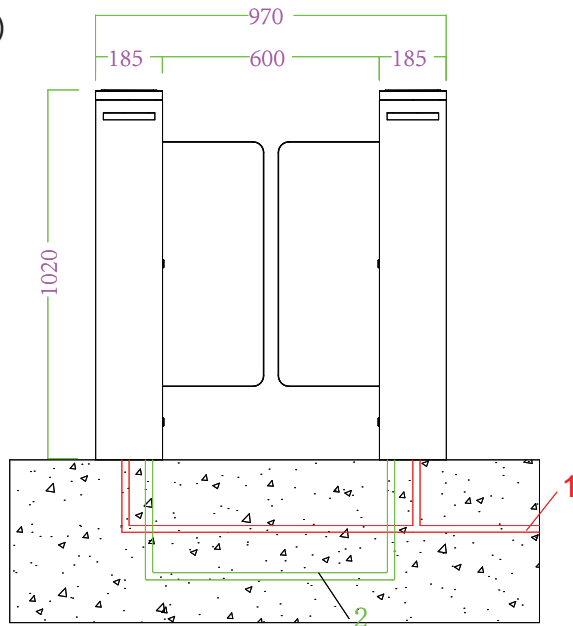

## Buried wires according to wiring diagram ahead of time

(Note: this device only needs power cords. If other access control equipment is installed, wiring can be done according to actual conditions.)



### Installation Manual:

- 1  The Ø20mm PVC tube for AC 220V Power wires (3XØ2.0mm)
- 2  The tube for connecting vice machine to master machine in the same lane (2 units: CAT5 network cable / 1 unit: 2 X 0.5mm motor line)
- 3  TCP/IP ethernet cable for connecting access device to PC
- 4  Control board
- 5  Fixing the equipment with M12 X 100mm expansive bolt

Mark: all wires extending out of the ground shall be no less than 2m

## Turnstile installation and fixation

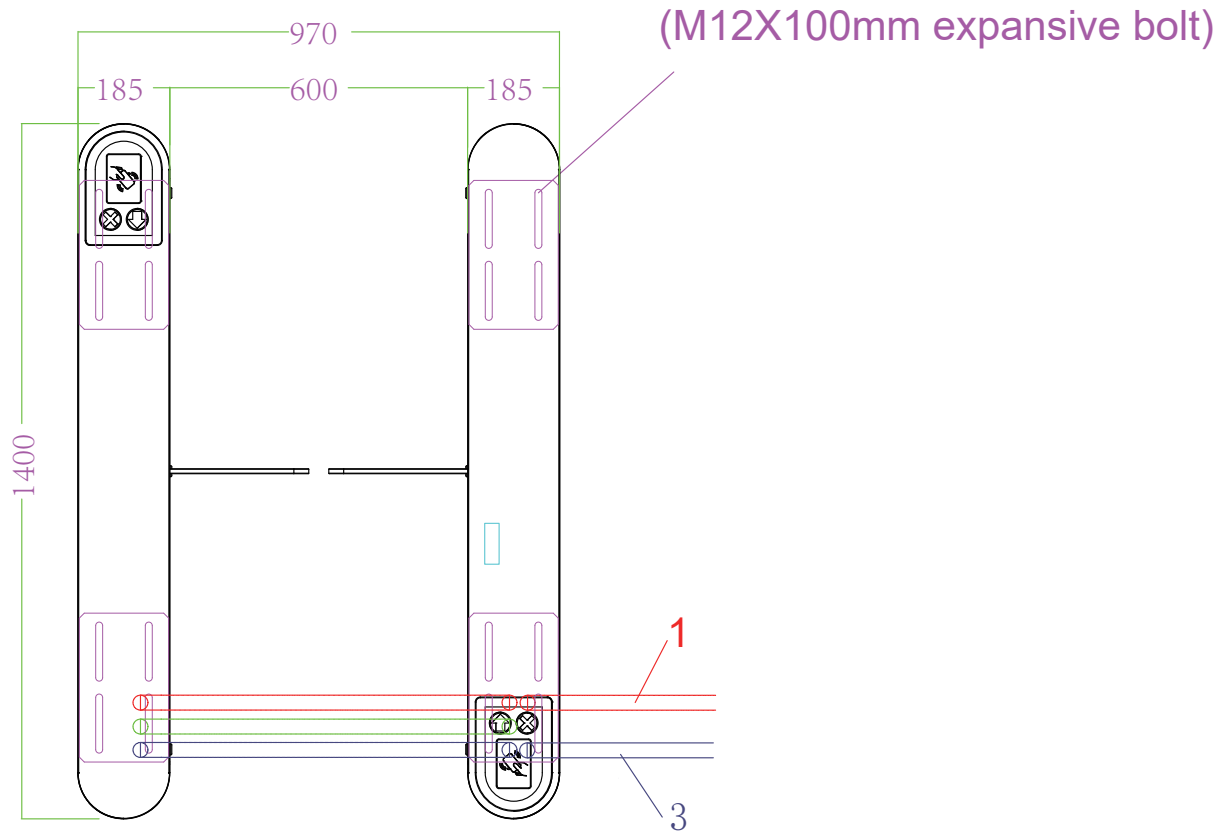



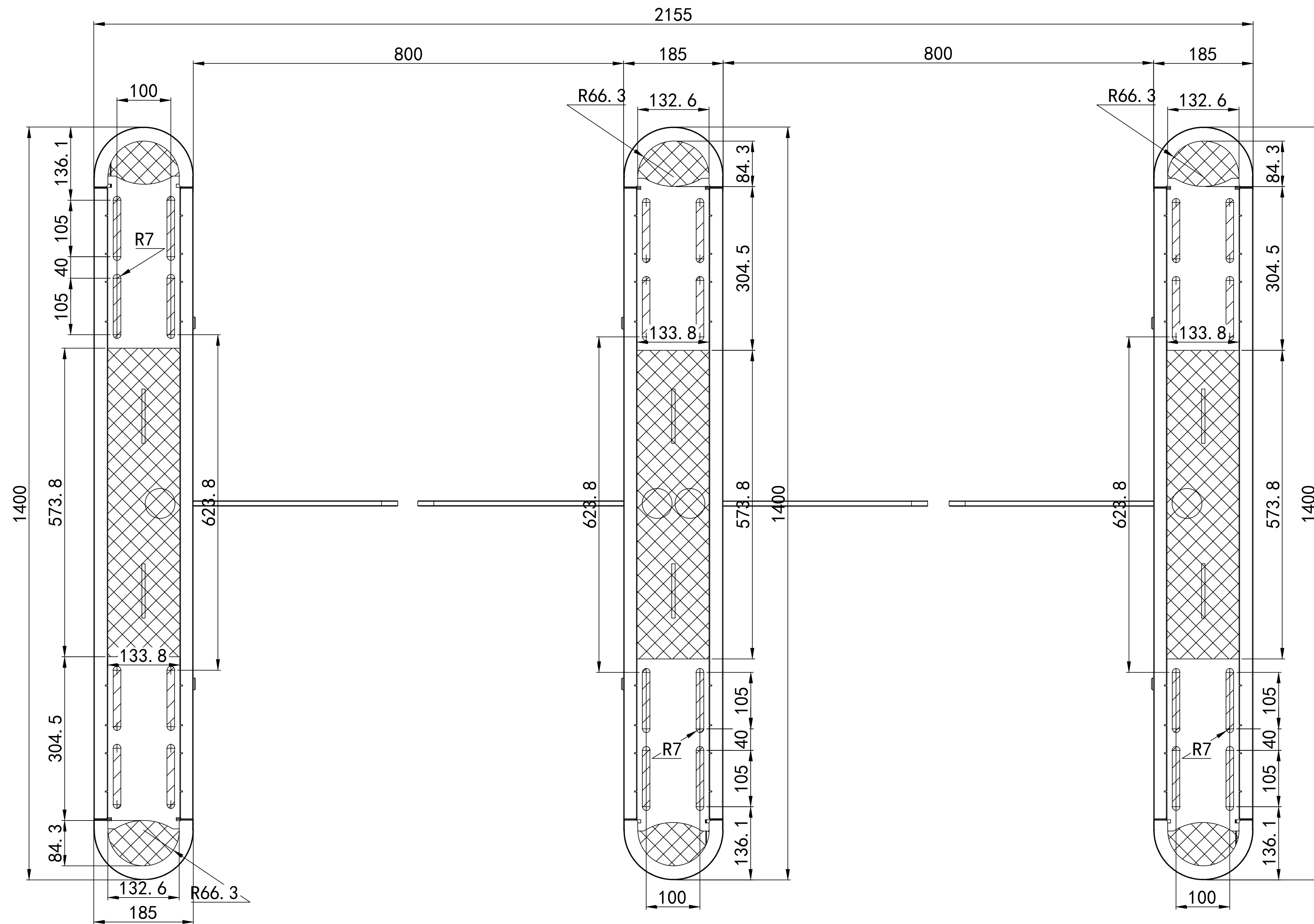
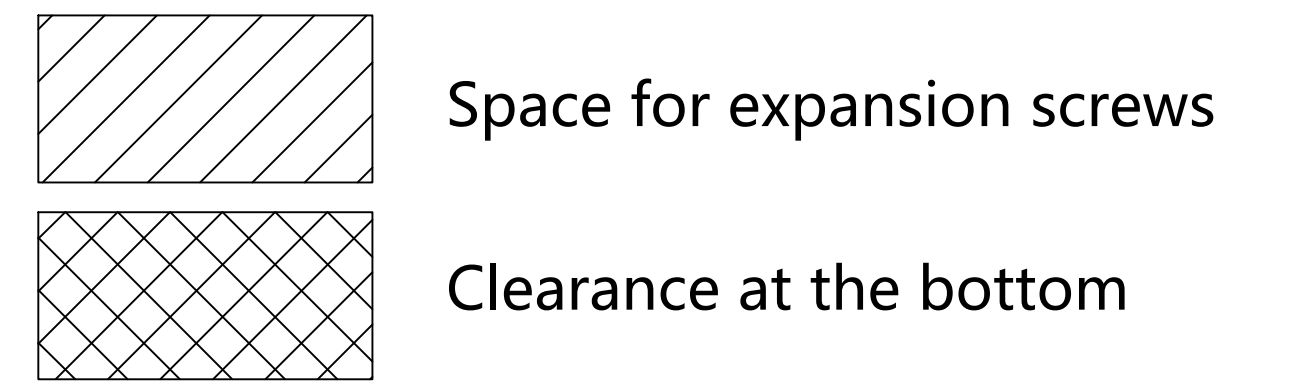

600 mm

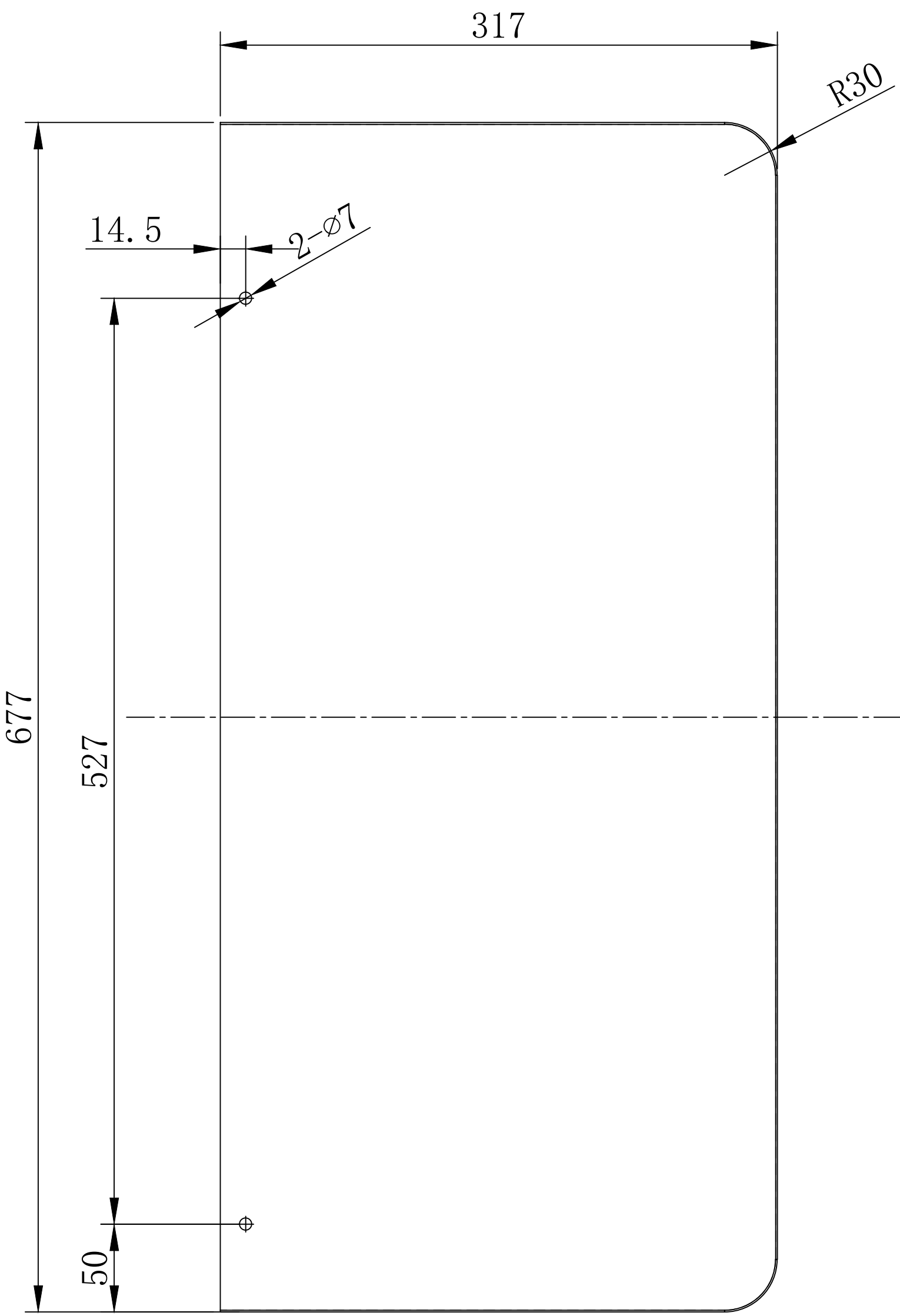

800 mm

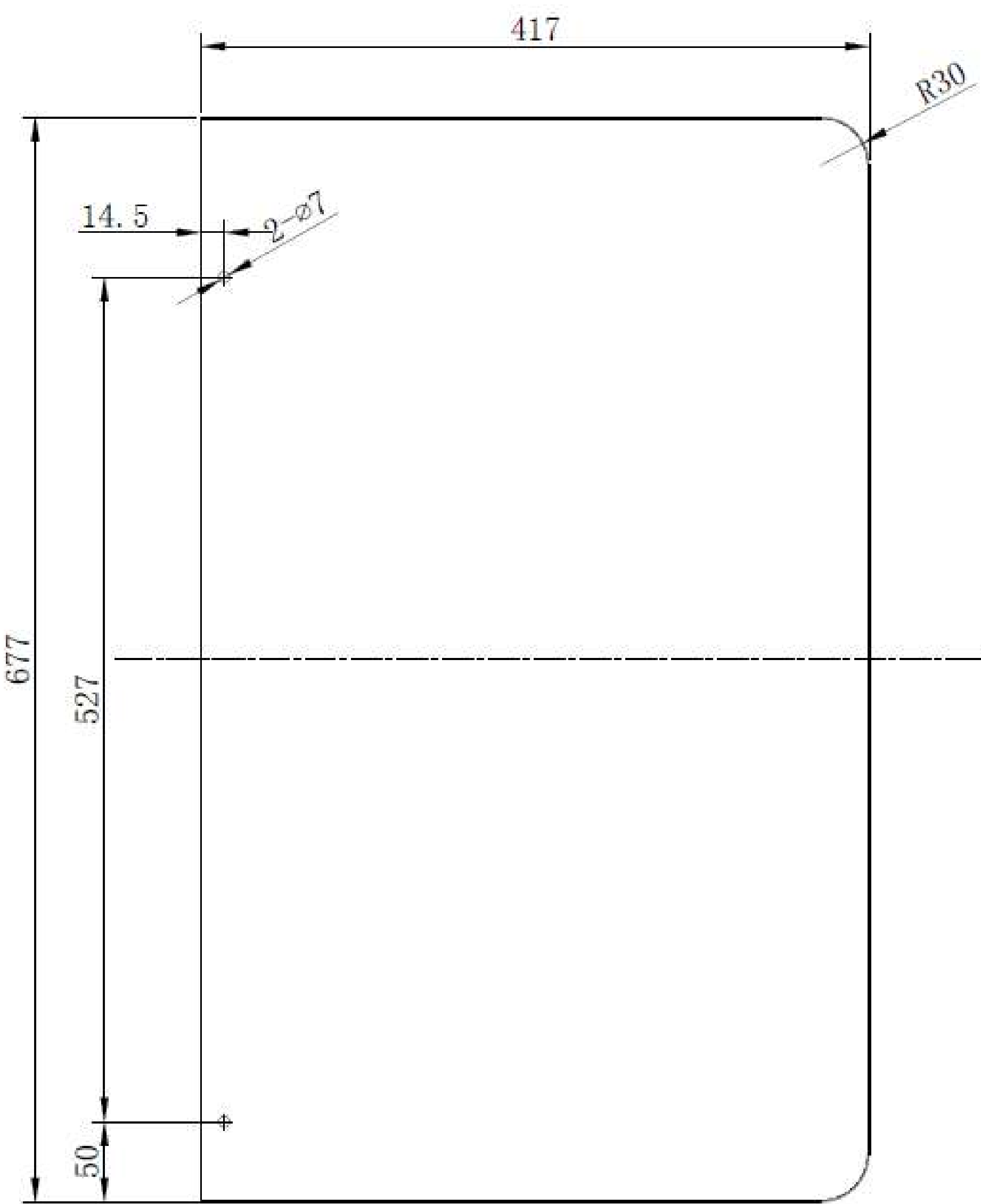

900 mm

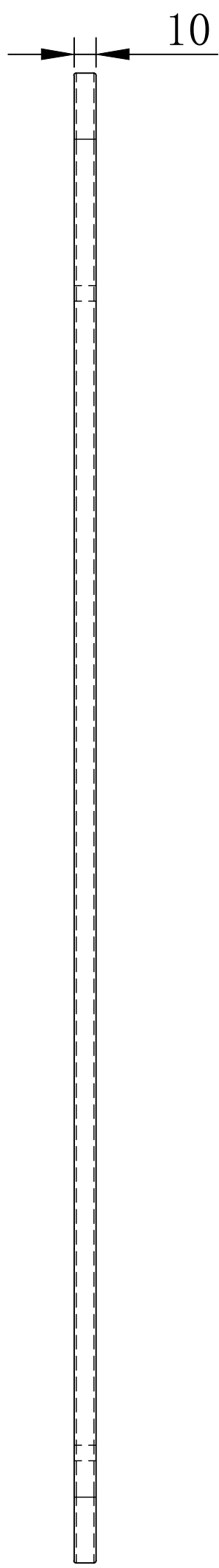
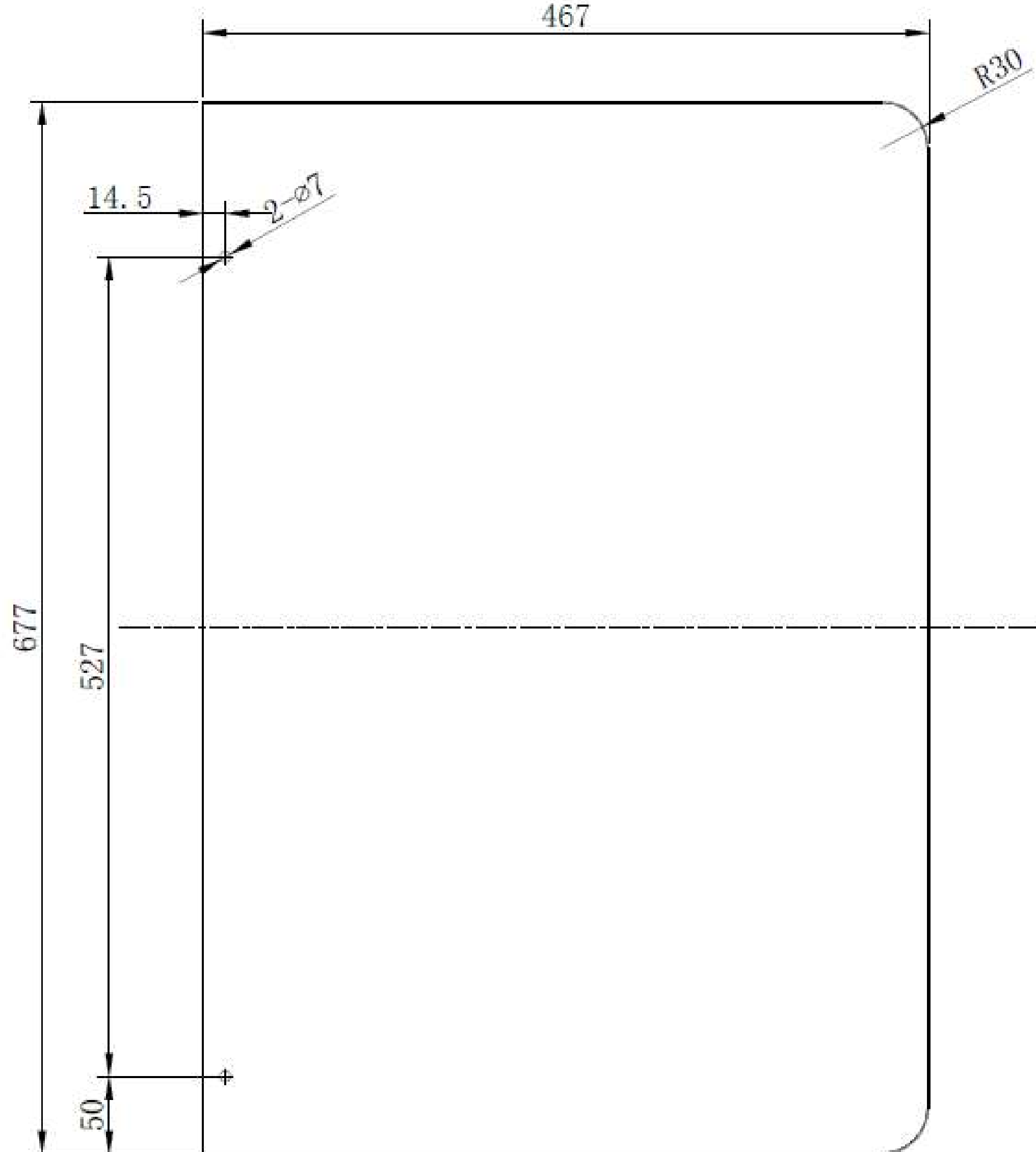



02

# Testing

## Testing

1. Check the wiring: According to the wiring diagram, check whether the online and power lines of the gate are connected correctly. Only after confirming that they are correct, the power can be turned on. If there are any abnormalities during the power on process, disconnect the power and check the connecting wires first.
2. Function debugging: After power on, the gate is opened and closed, then opened and finally closed. This process is a machine self-test, and the self-test is completed after two beeps of two seconds. Do not block the infrared during the process and do not stand in the channel.
3. When entering the channel without swiping the card, the gate will sound an alarm. If there is no alarm, please check if the infrared sensors are aligned. You can check if the infrared sensors on both sides are aligned and there is no alarm. In the case of obstruction, the tail of the receiving end is constantly lit with a red light. If the receiving end is constantly lit with a yellow light, it indicates that the infrared of the transmitting end and the receiving end are not aligned.
4. The unlocking time of the access control relay should be set to 0 seconds or 1 second.
5. When swiping a valid card, the indicator light turns into a green arrow. If the direction indicated by the indicator light is incorrect or if the entrance gate is closed immediately and an alarm is triggered, switch SW1 to SW2 wiring.
6. Carefully inspect and test to ensure that there are no abnormalities in the door opening and closing, the indicator lights are correct and the infrared anti pinch function is normal before putting it into use.

03

## Troubleshooting and Maintenance

# Troubleshooting

Question	Solution
1. The indicator light is not on	Switch to another test machine or use a good one to check the wiring
2. There is one indicator light with wrong direction	Swap the connection between D1 and D2 terminals of control board
3. After swiping the card, one side of the door wing remains stationary	Check if the wiring is loose. Power off and check if the connecting wires are properly connected. Check the electrical of the control board separately. The ports W, V, and U of the machine correspond one-to-one with the color of the line sequence
4. Open the gate upon entering the channel	Change the two-way free access mode of the control panel menu to card swiping mode
5. After swiping the card, enter the channel to sound an alarm and close the gate	Connect the opening signal to the two terminals of the anti adjustment control board: SW1 GND and SW2 GND.

# Note

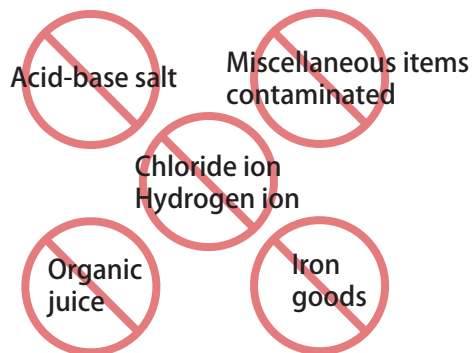

## Why does 304 stainless steel rust?

Environmental factors can cause corrosion and rusting of stainless steel, especially the presence of hydrogen ions and chloride ions. For example, hydrogen ions and chloride ions are present in table salt/sweat/sea water/sea breeze/soil, etc. Stainless steel corrodes quickly in the presence of chloride ions, even more than ordinary low carbon steel. Therefore, there are requirements for the working environment of stainless steel, and it needs to be wiped frequently to remove dust and keep clean and dry.



## Stainless Steel Turnstile Maintenance Manual

Type: **Surface dust, chemical liquid, dirt and acid and alkaline substances**

Solutions: Wash with wet soft non-woven cloth, then wipe clean, then scrub with alcohol, and then wipe the whole body of the turnstile with WD-40 rust remover;

Maintenance cycle: Weekly



Type: **The surface has rainbow patterns or the surface color is dull**

Solutions: Wash with wet soft cotton cloth, then wipe clean, then scrub with alcohol, and then wipe the whole body of the turnstile with WD-40 rust remover;

Maintenance cycle: Weekly



Type: **Check the moving parts for abnormal noise or looseness**

Solutions: Apply butter to the moving part

Maintenance cycle: Quarterly



Type: **Check if fasteners are loose or not and circuits is abnormal or not**

Solutions: If the fastener is loose, then fasten. If the circuit is abnormal, eliminate the problems.

Maintenance cycle: Annual





## **Maintenance tools and materials**

- 1) Cleaner: choose mild stainless steel cleaners and avoid using cleaners with acidic or alkaline ingredients
- 2) Soft cloth or sponge: spray cleaners on a soft cloth (or sponge) to clean the turnstile surface
- 3) Water: wash surface dirt
- 4) Drying cloth: wipe off surface moisture
- 5) WD-40 Rust Remover: remove rust caused by long-term exposure to corrosive environment
- 6) Lubrication: lubricate bearings, locking arms, transmission joint components

## **Note**

- 1) Avoid using cleaners with acidic or alkaline ingredients, which may make the surface rust
- 2) Avoid using sharp or hard objects to scratch the turnstile surface, which will affect the appearance of the turnstile surface
- 3) Keep surface dry, avoid making the turnstile in moisture for a long time. Water stains will cause stainless steel to rust. If there are water stains on the surface, wipe clean immediately
- 4) Regular inspection and maintenance, regularly check the turnstile surface condition to promptly find and resolve existing problems. If there are rust or scratches on the surface, please maintain or replace in time.

